

LOT 8

OWNER

BLOCK 31

*Samuel H. Goldsmith*

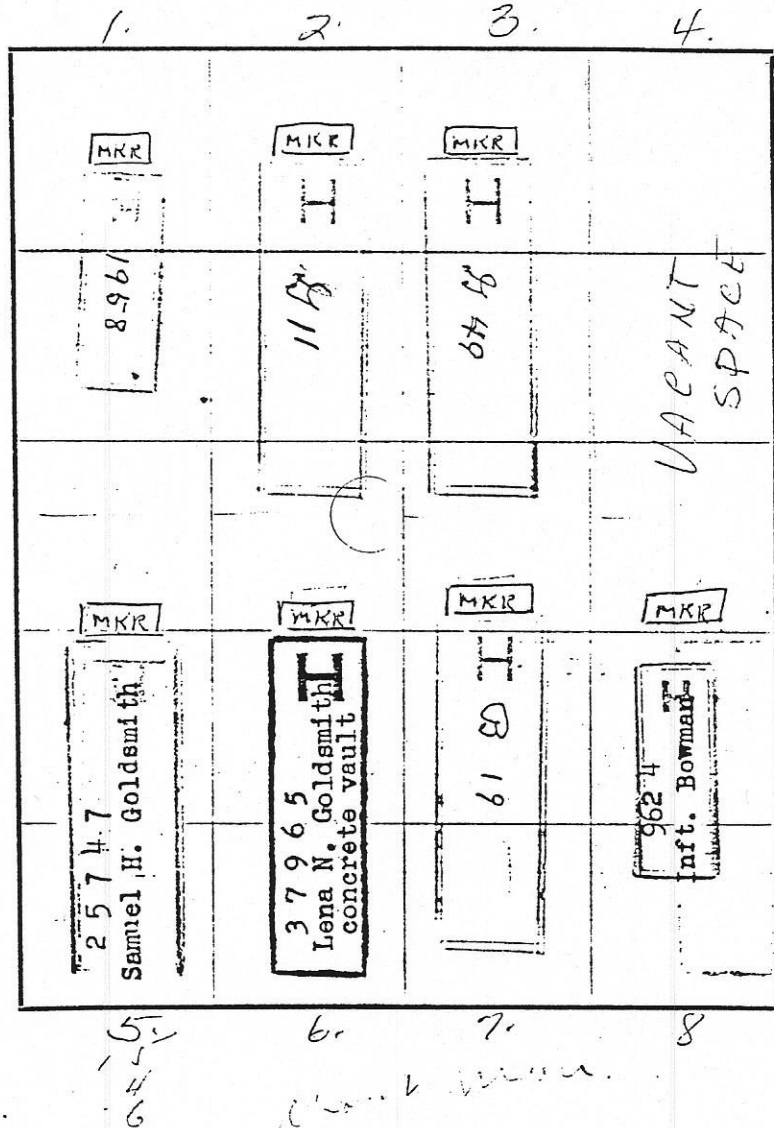

NO.	NAME	DATE	AGE			SEX	COL'R	UNDERTAKER
			YRS	MO	DYS			
B-19	Bornmann Samuel H.	9-2-1894						
9-49	Goldsmith Henry	9-2-1894			48			Bob Fitzg.
9-11	Goldsmith Eva	9-2-1894			72			B & J
1958	Goldsmith Henry N.	9-17-1897			20	M	W	"
9624	Bowman Inf. Son Clarence D	7-22-11				"	"	J. L. M.?
25747	Goldsmith Samuel H.	10/3/38	69	10	3	M	W	" "
37965	Goldsmith Lena N.	9-14-1966	90			F	W	T.G. McCarthy

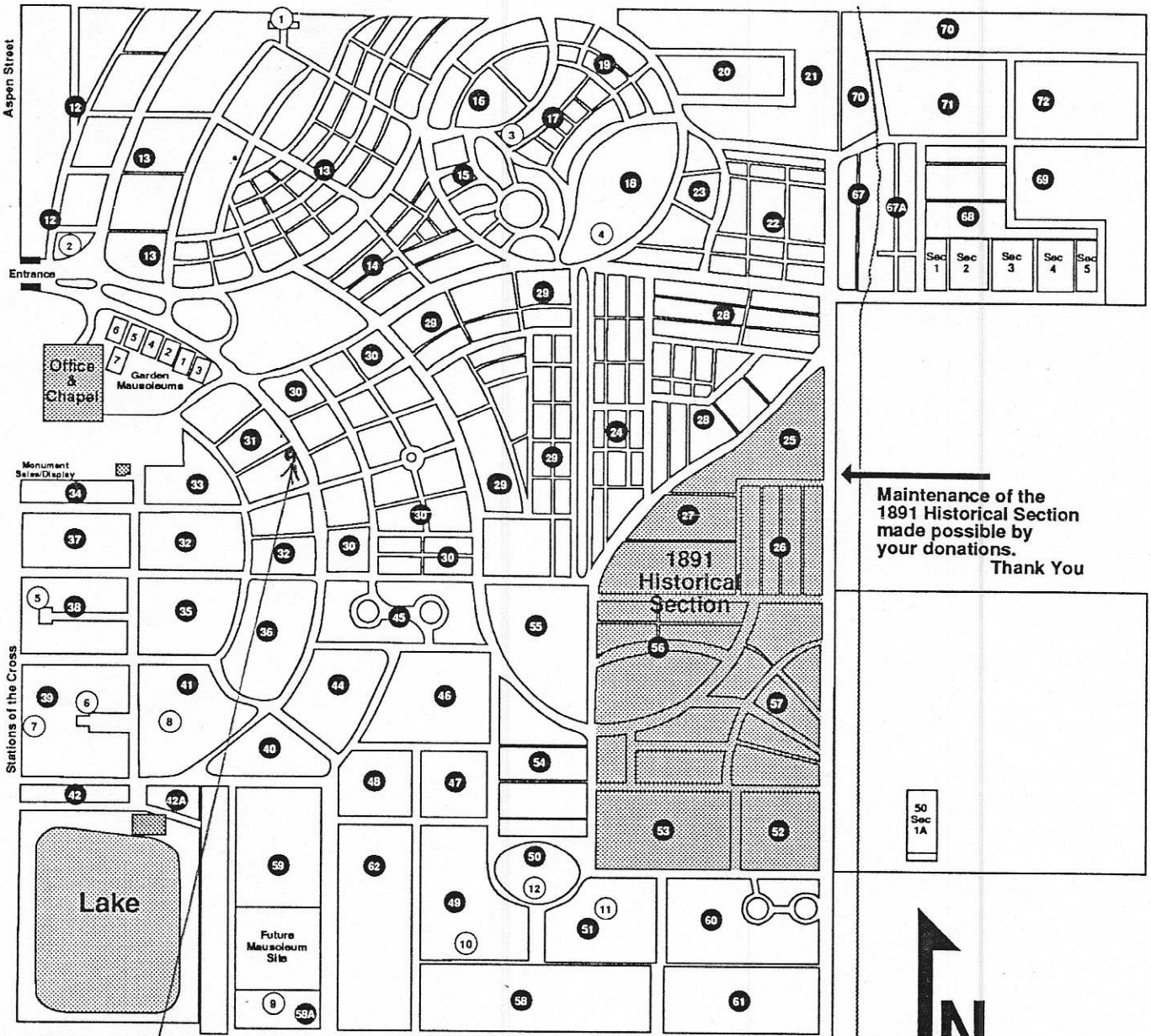

Maintenance of the 1891 Historical Section made possible by your donations. Thank You

50  
Sec 1A



- |                                  |  |
|----------------------------------|--|
| 1. Last Supper Feature           | 7. Stations of the Cross                       |
| 2. Civil War Cannons             | 8. Statue of Christ Feature                    |
| 3. Spanish American War Memorial | 9. Veterans Feature                            |
| 4. Elks Rest Feature             | 10. Holy Family Altar                          |
| 5. The Lord's Prayer Feature     | 11. Christ in the Garden of Gethsemane Feature |
| 6. Bishops Mausoleum             | 12. Baby Land Feature                          |

NAMES

*Samuel H. Goldsmith*

BLOCK

*31*

LOT

*#8 Spaces 1 thru 8*

**Roselawn**

CEMETERY AND MONUMENTS

1706 Roselawn Road

In the Country,  
on the Mesa.